

Chapter Test, Form 3B

Read each question carefully. Write your answer on the line provided.

1. Emily drew a square with a perimeter of 24 units. Shade the squares on the grid below to match her shape. Then find the area of the square.

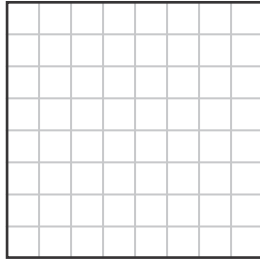

1. _____

2. Sam and his father are laying tile in two rooms. Find the area of each room. Then find the total area of the two rooms combined.

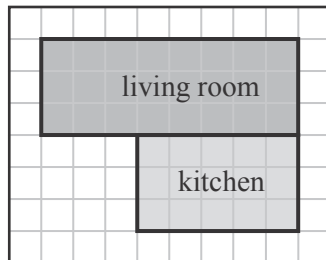

2. _____

3. Find the lengths of the missing sides. Then find the perimeter.

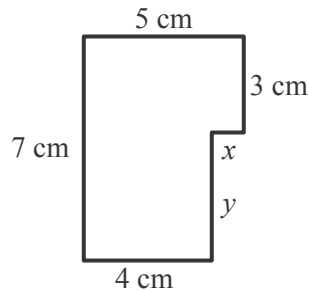

3. _____

List all the possible dimensions of rectangles for each area.

4. 16 units

4. _____

5. 20 units

5. _____

Chapter Test, Form 3B *(continued)*

6. What is the perimeter of a rectangle that has a width of 6 feet and a length of 7 feet? 6. _____

7. What is the perimeter of a square with sides that are 15 inches in length? 7. _____

8. Draw a picture of a rectangle that has a width of 6 inches and a length of 15 inches long. What is the area and perimeter of this rectangle? 8. _____

9. What is the area and perimeter of the figure below? 9. _____

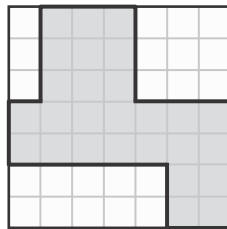

10. Draw a square that has a perimeter of 28 units and an area of 49 square units. 10.

11. Rectangle A has a perimeter of 30 in. Rectangle B has an area of 35 sq in. Which rectangle has a larger perimeter? Explain. 11. _____

12. Felicity is planting a garden. Should she measure the perimeter or area to find out how much dirt she needs to cover the garden? Explain. 12. _____

Chapter 13 Test

1. The rectangle has a length of 8 centimeters and an area of 24 square centimeters. 4.MD.3

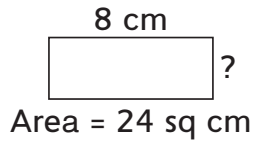

Part A: What is the width of the rectangle?

Part B: Draw in the square unit centimeters to show the area of the figure.

2. What is the next figure in this pattern? Draw the figure. What is the area of the figure? 4.MD.3

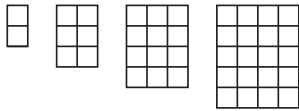

3. The length of a rectangle is twice the width of the rectangle. The perimeter of the rectangle is 36 inches. Complete the table. 4.MD.3

Length (in.)	Width (in.)	Perimeter (in.)	Area (sq. in.)

POWER UP FOR PARCC

On the actual test, you may drag items into boxes. In this book, you will write the values in the boxes.

4. Draw a line between each pair of matching items. 4.MD.3

square feet

length \times width

area of rectangle

perimeter units

inches

$(\text{length} \times 2) + (\text{width} \times 2)$

perimeter of rectangle

area units